



# Camp Lite™

by livin' lite

Truck Campers



## 2017 Décor Options

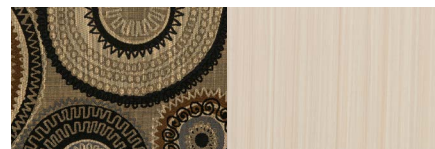

Alpine Package – fabric and cabinetry

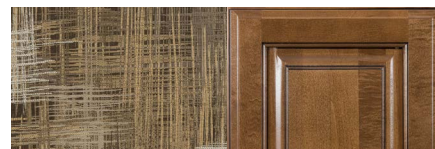

Sierra Package – fabric and cabinetry



Leather Options

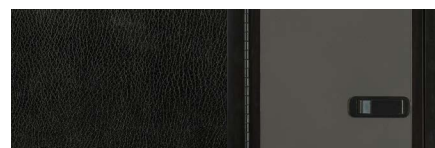

Opt. Aluminum Package –  
leather and cabinetry

## Standards

### Living Room/Kitchen

- All-Aluminum Tube Cabinet Structures
- Dual-Pane Euro Windows (double-acrylic tinted that open 90 degrees w/built-in day shade)
- Solid-Surface Countertops
- Bluetooth DVD/CD/MP3 Stereo w/USB Charger
- (2) Flush-Mount Interior Speakers
- Charging Center w/USB Ports
- Trek® Residential Freeze/Crack-proof Linoleum
- (3) Interior Color Choices, Incl. All-Aluminum
- Stainless Steel Sink w/High-Rise Faucet
- Flush-Mount Glass Cooktop Cover
- High-Efficient LED Lights
- 60 x 80 Mattress (F/P specific)

### Appliances

- Convection Microwave
- LP Refrigerator
- 2-Burner Stovetop
- Vented Range Hood w/Light
- 6 GAL LP/Electric DSI Water Heater
- High-Power 12V Vortex Fan
- LP Furnace

### Bath

- All-Aluminum Shower Surround
- Mirrored Medicine Cabinet

### Bedroom

- All Models have North/South Bed
- Overhead Cabinets
- Large Shirt Closet
- Hard Valances
- Nightshades

### Exterior/Construction Features

- 6-Sided Aluminum Super Structure
- Composite Material Throughout (water & mold resistant)
- 1 7/8" Laminated Floor w/F/G Block Foam & Azdel (No Wood = No Rot)
- Vacuum bonded Walls Laminated w/Azdel, 3-Tier Glue Process (stronger, more durable)
- .40 Aluminum Siding w/Full-body Automotive Paint (6 color choices)
- 6-Sided Block Foam Insulation, incl. Front Radius
- Alpha Superflex® Roof w/12-Year Limited Warranty (more durable, less chalking & streaking)
- Automotive-Style Rear Bumper
- Electric Camper Jacks
- Enclosed & Heated Underbelly
- Radius Entry Door
- Black Tank Flush
- Aluminum Tank Brackets
- Detachable Marine-Grade Power Cord
- Auxiliary Battery Box
- Pre-Wired Zamp® Solar
- Cable/Satellite Prep
- (2) Blue LED Lighted Exterior Speakers

- High Efficiency LED Lights
- Outside Shower w/Hot/Cold Water
- Diamond Plate Skirt Metal
- Radius Baggage doors w/Magnetic Catches
- Pre-Wired for Electric Jacks (all models)
- Electric Jacks Standard (8.4S, 10.0 & 11S)

### Options

- 11 BTU Coleman® Mach 1 A/C (runs on 2KW generator)
- External LP Hookup
- Electric Jacks (STD on 8.4S, 10 & 11S)
- Ladder
- Roof Rack
- Jackknife Sofa IPO Dinette (11S & 8.4S only)
- Fantastic Hi-Power Vent
- Side Box Awning
- Rear Awning
- Dually Brackets
- 12V Tank Heaters
- Canadian Standards
- RVIA Seal
- State Seal

### XL Living Package

Includes High-Power Vortex Vents (US only), Tank Monitor System, Audio Package w/24" TV, Decorative Wood Cabinet Fronts & Doors, Vinyl Flooring, Audio Visual Prep (incl. digital TV antenna, INT/EXT cable hookups, 12V/110 outlets by swivel TV bracket), INT/EXT LED 12V Light Package

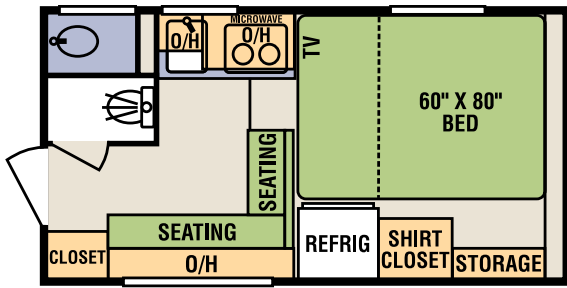

6.8

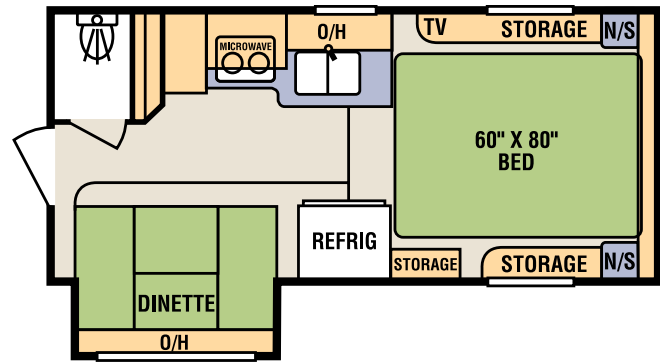

8.4s

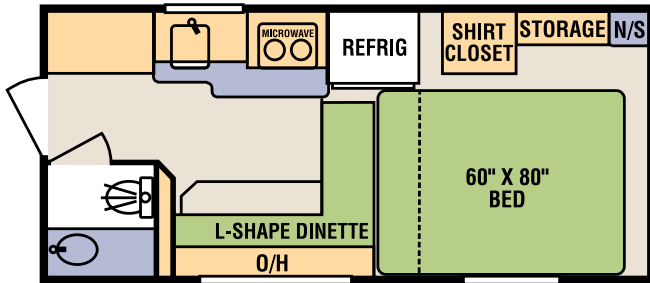

8.6

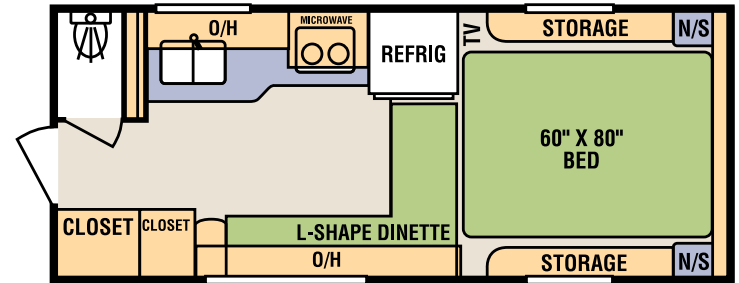

10.0

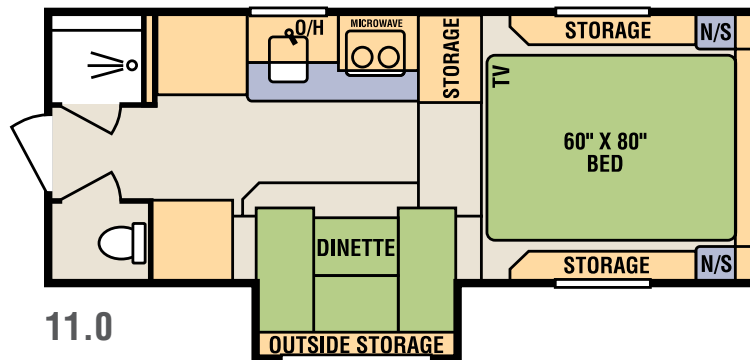

11.0

	6.8	8.4s	8.6	10.0	11.0
Unloaded Vehicle Weight* (lbs.)	TBD	3,027	TBD	2,995	3,180
Floor Length	6' 6"	8' 1"	8' 7"	10' 10"	11' 6"
Distance Between Wheel Wells	4' 0"	4' 0"	4' 0"	4' 0"	4' 0"
Interior Height	6' 8"	6' 8"	6' 8"	6' 8"	6' 8"
Exterior Height***	8' 9"	8' 9"	8' 9"	8' 9"	8' 9"
Exterior Width	7' 6"	**7' 6"	7' 6"	7' 6"	**7' 6"
Exterior Length	14' 2"	17' 4"	16' 5"	***19' 1"	***19' 11"
Fresh Water Capacity (gal.)	13	30.5	30.5	30.5	30.5
Black Water Capacity (gal.)	N/A	13	13	28	28
Gray Water Capacity (gal.)	32	17	17	34	32

6.8 uses a shared tank for gray and black water

\*This weight reflects the average unit weight for each model. Your truck weight will vary according to optional equipment. | \*\*With slide in | \*\*\*When off truck | \*\*\*\*Includes bumper